



FP0184BK

**FITTING INSTRUCTIONS FOR FP0184BK FORK PROTECTORS**  
**YAMAHA XSR700 2016-**



LEFT SIDE



RIGHT SIDE

**THIS KIT CONTAINS THE ITEMS PICTURED AND LABELLED BELOW.**  
**DO NOT PROCEED UNTIL YOU ARE SURE ALL PARTS ARE PRESENT.**

Please note that the way the kit is packed does not necessarily represent the way of mounting to the bike.

Please note that in cases where kits are packed with a plastic tube separating components on the spindle bar (this tube THE PARTS SHOWN MAY BE REPRESENTATIVE ONLY (FOR CLARITY OF INSTRUCTIONS ONLY)

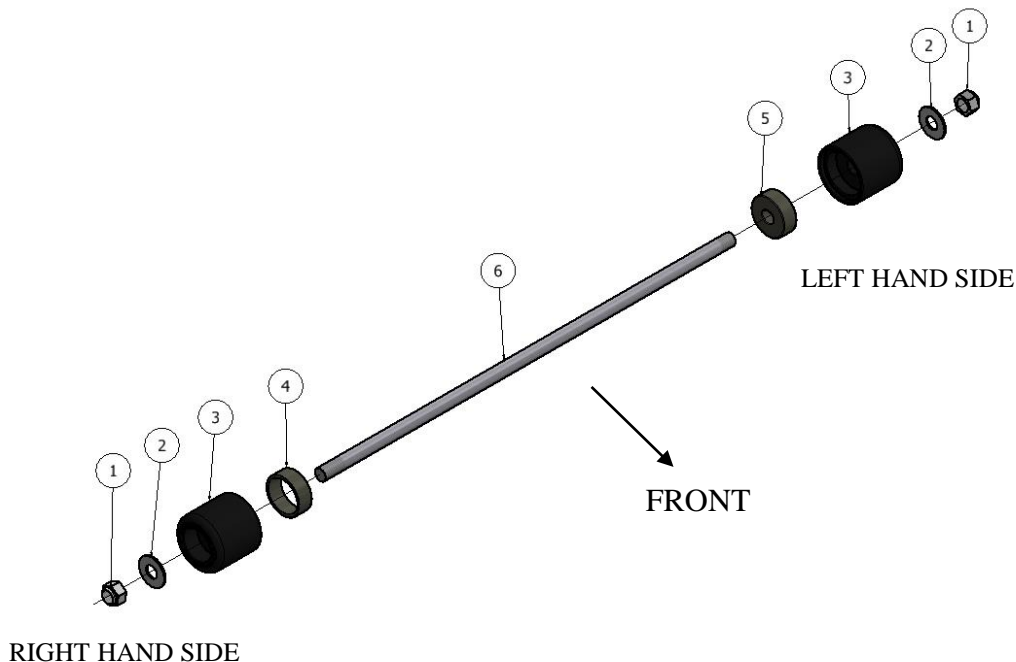



FP0184BK

## **LEGEND**

- ITEM 1 = 2 x M8 nyloc nuts
- ITEM 2 = 2 x M8 washers
- ITEM 3 = 2 x R&G Crash Bobbins (B0445M BK)
- ITEM 4 = 1 x R/H Spacer ID21mm 9mm long (S0951 BK)
- ITEM 5 = 1 x L/H Spacer ID8mm 9mm long (S0763 BK)
- ITEM 6 = 1 x Spindle bar 305mm long (SB015)

## **TOOLS REQUIRED**

- Socket set to include 2x 13mm sockets.
  - Wrenches

## **FITTING INSTRUCTIONS**

- Starting from the R/H, as you sit on the bike, fit R/H spacer S0951 (Item 4) over the Hexagon spindle head on the right hand side of the front spindle.
- Fit one M8 nyloc nut (Item 1) and M8 washer (Item 2) onto the end with shorter thread of the Spindle bar SB015 (Item 6) from the kit. Engage the nut so the nylon insert of the nut is fully engaged.
- Feed the spindle bar (SB015) with nut and washer through either R&G bobbin B0445M (Item 3) and through the spacer just fitted on the right hand side of the front spindle.
- Place the remaining spacer (S0763 – Item 5) on the exposed left hand spindle bar so the spacer sits against the threaded end of the OEM front spindle. Then slide the remaining R&G bobbin B0455M (Item 3) onto the spindle bar.
- Fit the remaining M8 washer (Item 2) and nyloc nut (Item 1) from the kit onto the thread and tighten until both nuts are engaged in nylon.
- Do not overtighten – the nyloc nuts will hold it tight

ISSUE 1 18/04/2016 (HH)

## **CONSUMER NOTICE**

The catalogue description and any exhibition of samples are only broad indications of the Products and R&G may make design changes which do not diminish their performance or visual appeal and supplying them in such state shall conform to the order. The Buyer acknowledges no representation or warranty (other than as to title) has been given or will apply to the Products other than those in R&G's order or confirmation and the Buyer confirms it has chosen the Products as being of merchantable quality and suitable for its particular purposes. Where R&G fits the Products or undertakes other services it shall exercise reasonable skill and care and rectify any fault free of charge unless the workmanship has been disturbed. The Buyer is responsible for ensuring that the warranty on the motorcycle is not affected by the fitting of the Products. On return of any defective Products R&G shall at its option either supply a replacement or refund the purchase money but shall not be liable if the Products have been modified or used or maintained otherwise than in accordance with R&G's or manufacturer's instructions and good engineering practice or if the defect arises from accident or neglect. Other than identified above and subject to R&G not limiting its liability for causing death and personal injury, it shall not be liable for indirect or consequential loss and otherwise its liability shall be limited to the amounts paid by the Buyer for the Products or the fitting or service concerned. These terms do not affect the Buyer's statutory rights.

## **R&G RACING RETURNS POLICY (NON-FAULTY GOODS)**

Returns must be pre-authorized (if not pre-authorized the return will be rejected). Goods may only be returned direct to us if they were purchased direct from us (customer must prove if necessary). Otherwise to be returned to original vendor. Goods must be in re-sellable condition, in the opinion of R&G Racing. All returns are subject to a 25% restocking and handling fee (25% of the gross value exc. P&P – at the prevailing price at time of purchase). The customer must pay any and all carriage charges. No returns of discontinued products, unless within 14 days of purchase. This policy does not affect your statutory rights and does not refer to faulty goods.

R&G Racing

Unit 1, Shelley's Lane, East Worldham, Alton, Hampshire, GU34 3AQ

Tel: +44 (0)1420 89007 Fax: +44 (0)1420 87301 [www.rg-racing.com](http://www.rg-racing.com) Email: [info@rg-racing.com](mailto:info@rg-racing.com)



FP0184BK

**NOTICE DE MONTAGE POUR FP0184BK PROTECTIONS FOURCHE  
YAMAHA XSR700 2016-**



COTE GAUCHE



COTE DROIT

**Le kit contient les articles exposés ci-dessous, vérifier que toutes les pièces soient présentes avant de procéder au montage.**

**LA FAÇON DONT LE KIT EST EMBALLE NE CORRESPOND PAS FORCEMENT A LA FAÇON DE MONTER LES PIÈCES SUR LA MOTO.**

Notez que si les kits sont emballés avec un tube en plastique qui sépare les composants sur l'axe, ce tube doit être jeté).

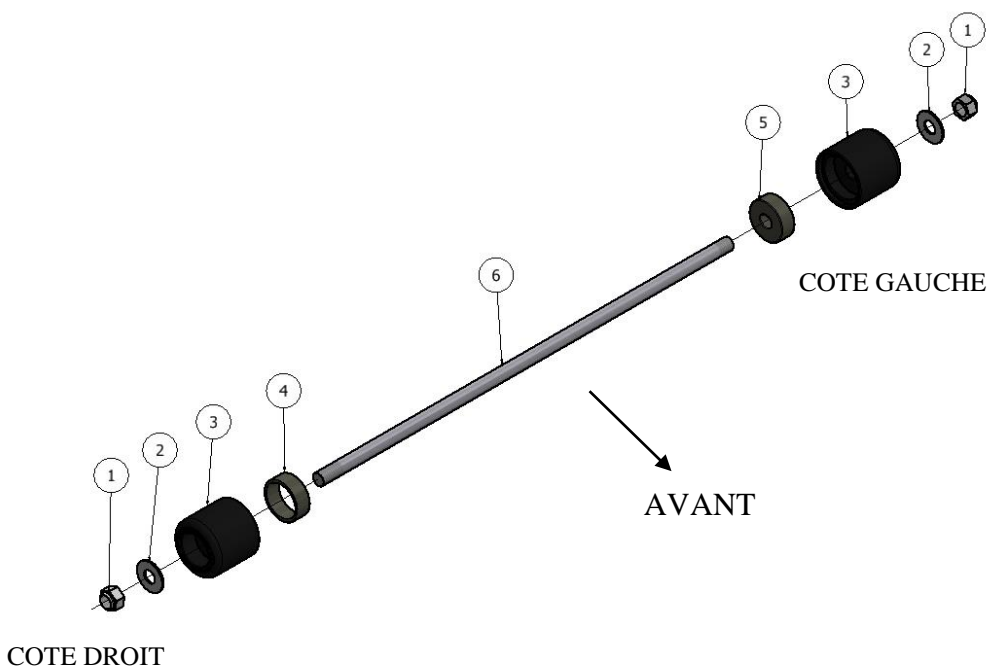



FP0184BK

## **LEGENDE**

- ARTICLE 1 = 2 x M8 Ecrous
- ARTICLE 2 = 2 x M8 Rondelles
- ARTICLE 3 = 2 x R&G Protections crash (B0445M BK)
- ARTICLE 4 = 1 x R/H Entretoise ID21mm 9mm de long (S0951 BK)
- ARTICLE 5 = 1 x L/H Entretoise ID8mm 9mm de long (S0763 BK)
- ARTICLE 6 = 1 x Axe 305mm de long (SB015)

## **OUTILS REQUIS**

- Clé à cliquet 2x 13mm.

## **NOTICE DE MONTAGE**

- Commencer du coté droit (lorsqu'on est assis sur la moto) insérer une entretoise S0951 (Article 4) sur la tête de l'axe du coté droit de l'axe avant.
- Insérer un écrou M8 (Article 1) et une rondelle M8 (Article 2) sur l'extrémité du filetage le plus court de l'axe SB015 (Article 6) du kit. Engager l'écrou de façon à ce que l'insert de l'écrou soit complètement engagé.
- Passer l'axe (SB015) avec écrou et rondelle dans l'une des bobines R&G B0445M (Article 3) et à travers l'entretoise tout juste insérée du coté droit de l'axe.
- Placer l'entretoise restante (S0763 – Article 5) sur l'extrémité de l'axe de façon à ce que l'entretoise se place contre l'extrémité filetée de l'axe d'origine. Ensuite, glisser la bobine R&G B0445M (Article 3) sur l'axe.
- Insérer la rondelle M8 restante (Article 2) et l'écrou (Article 1) du kit sur le filetage et serrer jusqu'à ce que les 2 écrous soient engagés dans le nylon.
- **NE PAS TROP SERRER – Les écrous bloquent suffisamment.**

ISSUE 1 18/04/2016 (HH)

### **CONSUMER NOTICE**

The catalogue description and any exhibition of samples are only broad indications of the Products and R&G may make design changes which do not diminish their performance or visual appeal and supplying them in such state shall conform to the order. The Buyer acknowledges no representation or warranty (other than as to title) has been given or will apply to the Products other than those in R&G's order or confirmation and the Buyer confirms it has chosen the Products as being of merchantable quality and suitable for its particular purposes. Where R&G fits the Products or undertakes other services it shall exercise reasonable skill and care and rectify any fault free of charge unless the workmanship has been disturbed. The Buyer is responsible for ensuring that the warranty on the motorcycle is not affected by the fitting of the Products. On return of any defective Products R&G shall at its option either supply a replacement or refund the purchase money but shall not be liable if the Products have been modified or used or maintained otherwise than in accordance with R&G's or manufacturer's instructions and good engineering practice or if the defect arises from accident or neglect. Other than identified above and subject to R&G not limiting its liability for causing death and personal injury, it shall not be liable for indirect or consequential loss and otherwise its liability shall be limited to the amounts paid by the Buyer for the Products or the fitting or service concerned. These terms do not affect the Buyer's statutory rights.

### **R&G RACING RETURNS POLICY (NON-FAULTY GOODS)**

Returns must be pre-authorized (if not pre-authorized the return will be rejected). Goods may only be returned direct to us if they were purchased direct from us (customer must prove if necessary). Otherwise to be returned to original vendor. Goods must be in resellable condition, in the opinion of R&G Racing. All returns are subject to a 25% restocking and handling fee (25% of the gross value exc. P&P – at the prevailing price at time of purchase). The customer must pay any and all carriage charges. No returns of discontinued products, unless within 14 days of purchase. This policy does not affect your statutory rights and does not refer to faulty goods.

R&G Racing

Unit 1, Shelley's Lane, East Worldham, Alton, Hampshire, GU34 3AQ

Tel: +44 (0)1420 89007 Fax: +44 (0)1420 87301 [www.rg-racing.com](http://www.rg-racing.com) Email: [info@rg-racing.com](mailto:info@rg-racing.com)